

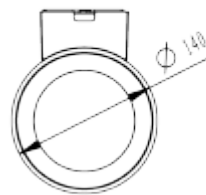

## FDV SPEC SHEET

Dalim Up or Down 1200lm 40° 20W Dark Grey Phasecut  
Art. no: 2435-40-7

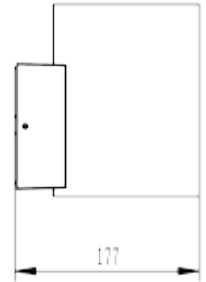

# Dalim Up or Down 1200lm 40° 20W Dark Grey Phasecut



Art. no: 2435-40-7

LIGHT TECHNICAL	
Lightsource Type:	LED (built in)
Lumen Output:	1101
Lumen LED (tc=25):	1200
Beam Angle:	40°
CCT (Color Temperature):	3000
CRI / Ra:	80
Color Code:	830
Lens (Diffuser):	Clear
MOUNTING / CONNECTION	
Connection:	QuickConnect
Mounting:	Surface, Wall

ELECTRICAL DATA	
Dimming:	Phase-Cut
System Power [W]:	20
System Voltage [V]:	230V 50Hz
Protection Class:	1
Max load pr circuit - B10:	12
Max load pr circuit - B16:	19
Max load pr circuit - C10:	23
Max load pr circuit - C16:	39
Leakage current [mA]:	0,1
Inrush current I <sub>max</sub> [A]:	4,1
Inrush current time [µs]:	1,7
Socket / Cap-Base:	N/A



## FDV SPEC SHEET

Dalim Up or Down 1200lm 40° 20W Dark Grey Phasecut  
Art. no: 2435-40-7



### PRODUCT

Ingress Protection:	IP65
Impact Protection:	IK08
Operating Temperature [°C]:	-20 - 50
Lifetime [h]:	L80: 100 000
Color:	Dark Grey
RAL:	RAL7024
Length [mm]:	177
Height [mm]:	185
Width [mm]:	140
Weight [kg]:	1,8
Housing Material :	Aluminium