



## PRODUCT SHEET

Tube Wall Up&Down 2x2750lm 830 45° 39W IP65 Ø155x250mm D.GR

Art. no: 1076-45-1



Lighting Solutions

# Tube Wall Up&Down 2x2750lm 830 45° 39W IP65 Ø155

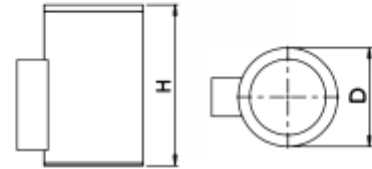

D, mm	H, mm
155	464
	250



### SPECIFICATIONS

System Power [W]:	39W
CCT (Color Temperature):	3000K
CRI / Ra:	80
Lumen Output:	4111lm
Lumen LED (tc=25):	5558lm
Beam Angle:	45°
Lens (Diffuser):	None
Dimming:	None
System Voltage [V]:	230V 50Hz
Connection:	Terminal
Mounting:	Surface, Wall
Lifetime [h]:	L80B10: 100 000h
MacAdam (SDCM):	3
Color:	Dark Grey
Height [mm]:	464mm
Width [mm]:	155mm
Weight [kg]:	3,2kg

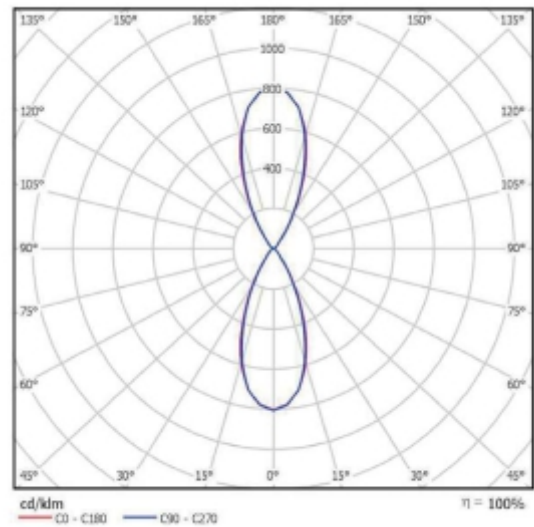

Tube Wall Up&