

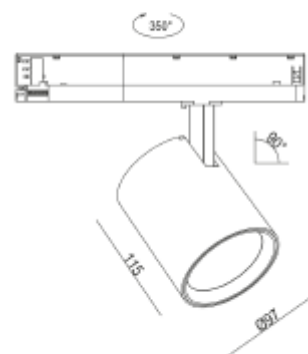

FDV SPEC SHEET

Rod Maxi C

Art. no: 102320-40-2

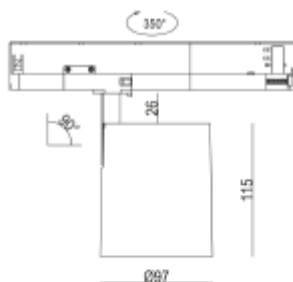
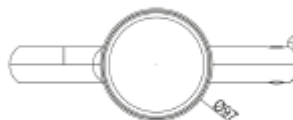

Rod Maxi C



Art. no: 102320-40-2

LIGHT TECHNICAL

Lightsource Type:	LED (built in)
Lumen Output:	3861
Lumen LED (tc=25):	4800
Beam Angle:	40°
CCT (Color Temperature):	3000
CRI / Ra:	90
Color Code:	930
MacAdam (SDCM):	3
Lens (Diffuser):	Clear

MOUNTING / CONNECTION

Connection:	Track 3-Circuit
Mounting:	Track, Ceiling

ELECTRICAL DATA

Dimming:	None
Flickerfree:	Yes
System Power [W]:	27
System Voltage [V]:	230V 50Hz
Protection Class:	2
Max load pr circuit - B10:	17
Max load pr circuit - B16:	27
Max load pr circuit - C10:	28
Max load pr circuit - C16:	44
Leakage current [mA]:	0,25
Inrush current I _{max} [A]:	18
Inrush current time [μs]:	2,8
Current Output [mA]:	650



FDV SPEC SHEET

Rod Maxi C

Art. no: 102320-40-2



PRODUCT	
Ingress Protection:	IP20
Impact Protection:	IK02
Lifetime [h]:	L80B10: 100 000
Color:	Black
RAL:	RAL9005
Height [mm]:	115
Diameter [mm]:	97
Weight [kg]:	0,6
Housing Material :	Aluminium
Diffuser Material:	Aluminium
Material 2:	Polycarbonate