

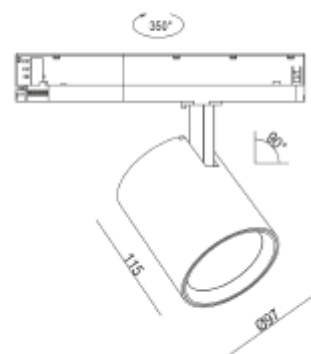

## FDV SPEC SHEET

Rod Maxi C

Art. no: 102321-20-3

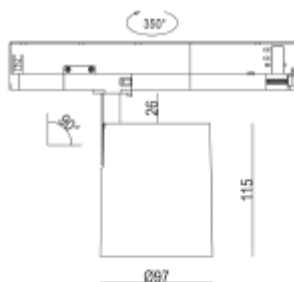
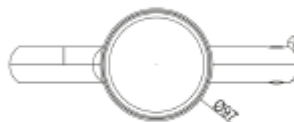

## Rod Maxi C



Art. no: 102321-20-3

### LIGHT TECHNICAL

Lightsource Type:	LED (built in)
Lumen LED (tc=25):	3450
Beam Angle:	20°
CCT (Color Temperature):	3000
CRI / Ra:	90
Color Code:	930
Lens (Diffuser):	Clear

### MOUNTING / CONNECTION

Connection:	18i3 Quick connection
Mounting:	Track, Ceiling

### ELECTRICAL DATA

Dimming:	None
Flickerfree:	Yes
System Power [W]:	27
System Voltage [V]:	230V 50Hz
Protection Class:	2
Max load pr circuit - B10:	17
Max load pr circuit - B16:	27
Max load pr circuit - C10:	28
Max load pr circuit - C16:	44
Leakage current [mA]:	0,25
Inrush current I <sub>max</sub> [A]:	18
Inrush current time [μs]:	2,8
Socket / Cap-Base:	N/A



## FDV SPEC SHEET

Rod Maxi C

Art. no: 102321-20-3



### PRODUCT

Ingress Protection:	IP20
Impact Protection:	IK02
Lifetime [h]:	L80B10: 100 000
Color:	White
Height [mm]:	115
Diameter [mm]:	97
Housing Material :	Aluminium
Diffuser Material:	Aluminium
Material 2:	Polycarbonate