



FDV SPEC SHEET

Rod Midi C

Art. no: 102313-30-1

NORLUX®

Lighting Solutions

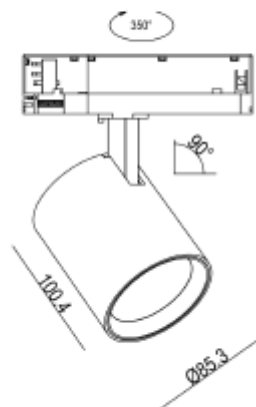
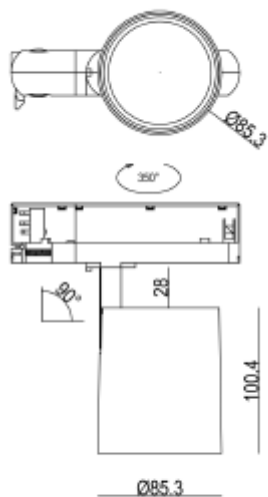

Rod Midi C

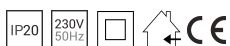

Art. no: 102313-30-1

LIGHT TECHNICAL

Lightsource Type:	LED (built in)
Lumen Output:	2990
Lumen LED (tc=25):	4100
Beam Angle:	30
CCT (Color Temperature):	4000
CRI / Ra:	90
Color Code:	940
MacAdam (SDCM):	3
Lens (Diffuser):	Clear
UGR (<=):	19

MOUNTING / CONNECTION

Connection:	Track 3-Circuit
Mounting:	Track



FDV SPEC SHEET

Rod Midi C

Art. no: 102313-30-1



PRODUCT	
Ingress Protection:	IP20
Impact Protection:	IK02
Operating Temperature [°C]:	-20 - 45
Lifetime [h]:	L80: 100 000
Color:	Grey
RAL:	RAL7035
Height [mm]:	115
Diameter [mm]:	97
Weight [kg]:	0,66
Housing Material :	Aluminium
Diffuser Material:	Aluminium
Material 2:	Polycarbonate

ELECTRICAL DATA	
Dimming:	None
Flickerfree:	Yes
Standby power Psb (W) <:	0,5
Flicker metric (Pst LM) <:	0,037
Stroboscopic effect metric (SVM) <	0,009
System Power [W]:	23
System Voltage [V]:	230V 50Hz
Protection Class:	2
Max load pr circuit - B10:	56
Max load pr circuit - B16:	89
Max load pr circuit - C10:	56
Max load pr circuit - C16:	89
Leakage current [mA]:	0,55
Inrush current Imax [A]:	2,025
Inrush current time [µs]:	70
Socket / Cap-Base:	N/A
Current Output [mA]:	600
Voltage Forward Min [V]:	33
Voltage Forward Max [V]:	38
Emergency light [h]:	No Emergency light