

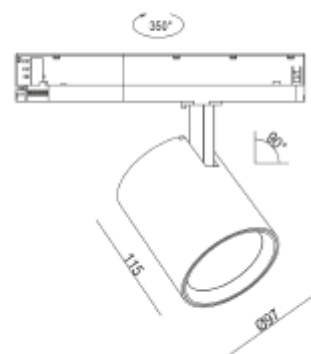

## FDV SPEC SHEET

Rod Maxi C

Art. no: 102322-30-3

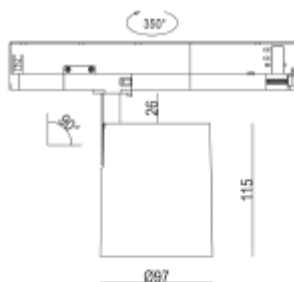
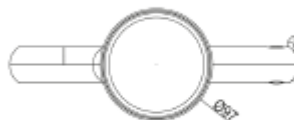

## Rod Maxi C



Art. no: 102322-30-3

### LIGHT TECHNICAL

Lightsource Type:	LED (built in)
Lumen Output:	3700
Lumen LED (tc=25):	4752
Beam Angle:	30
CCT (Color Temperature):	3500
CRI / Ra:	90
Color Code:	935
MacAdam (SDCM):	3
Lens (Diffuser):	Clear
UGR (<=):	19

### MOUNTING / CONNECTION

Connection:	Track 3-Circuit
Mounting:	Track, Ceiling



## FDV SPEC SHEET

Rod Maxi C

Art. no: 102322-30-3



PRODUCT		ELECTRICAL DATA	
Ingress Protection:	IP20	Dimming:	None
Impact Protection:	IK02	Flickerfree:	Yes
Operating Temperature [°C]:	-20 - 45	Standby power Psb (W) <:	0,5
Lifetime [h]:	L80: 100 000	Flicker metric (Pst LM) <:	0,037
Color:	White	Stroboscopic effect metric (SVM) <	0,009
RAL:	RAL9010	System Power [W]:	27
Height [mm]:	115	System Voltage [V]:	230V 50Hz
Diameter [mm]:	97	Protection Class:	2
Weight [kg]:	0,75	Max load pr circuit - B10:	38
Housing Material :	Aluminium	Max load pr circuit - B16:	62
Diffuser Material:	Aluminium	Max load pr circuit - C10:	38
Material 2:	Polycarbonate	Max load pr circuit - C16:	62
		Leakage current [mA]:	0,26
		Inrush current Imax [A]:	1,86
		Inrush current time [µs]:	68
		Socket / Cap-Base:	N/A
		Current Output [mA]:	700
		Voltage Forward Min [V]:	33
		Voltage Forward Max [V]:	38
		Emergency light [h]:	No Emergency light