

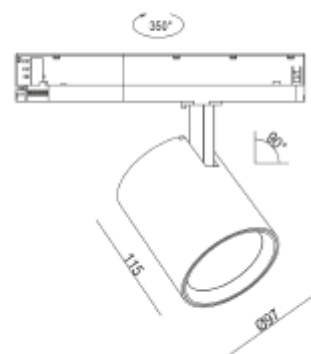

## FDV SPEC SHEET

Rod Maxi C

Art. no: 102323-30-3

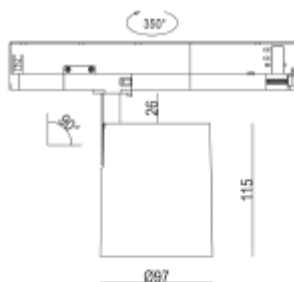
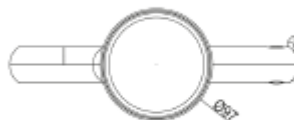

## Rod Maxi C



Art. no: 102323-30-3

### LIGHT TECHNICAL

Lightsource Type:	LED (built in)
Lumen Output:	3700
Lumen LED (tc=25):	4752
Beam Angle:	30
CCT (Color Temperature):	4000
CRI / Ra:	90
Color Code:	940
MacAdam (SDCM):	3
Lens (Diffuser):	Clear
UGR (<=):	19

### MOUNTING / CONNECTION

Connection:	Track 3-Circuit
Mounting:	Track, Ceiling



## FDV SPEC SHEET

Rod Maxi C

Art. no: 102323-30-3



PRODUCT	
Ingress Protection:	IP20
Impact Protection:	IK02
Operating Temperature [°C]:	-20 - 45
Lifetime [h]:	L80: 100 000
Color:	White
RAL:	RAL9010
Height [mm]:	115
Diameter [mm]:	97
Weight [kg]:	1,04
Housing Material :	Aluminium
Diffuser Material:	Aluminium
Material 2:	Polycarbonate

ELECTRICAL DATA	
Dimming:	None
Flickerfree:	Yes
Standby power Psb (W) <:	0,5
Flicker metric (Pst LM) <:	0,037
Stroboscopic effect metric (SVM) <	0,009
System Power [W]:	27
System Voltage [V]:	230V 50Hz
Protection Class:	2
Max load pr circuit - B10:	38
Max load pr circuit - B16:	62
Max load pr circuit - C10:	38
Max load pr circuit - C16:	62
Leakage current [mA]:	0,26
Inrush current Imax [A]:	1,86
Inrush current time [µs]:	68
Socket / Cap-Base:	N/A
Current Output [mA]:	700
Voltage Forward Min [V]:	33
Voltage Forward Max [V]:	38
Emergency light [h]:	No Emergency light